

brinno
brilliant innovation

PHV MAC

Motion
Activated
PeepHole Camera
User Manual

Wirefree Security

Register @online

www.brinno.com/support/register.html

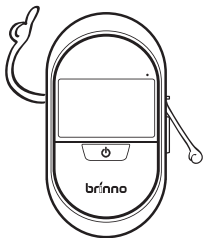

contents

Introducing	04
Features	05
Package Contents	06
Device Parts	07
Display Icons	08
Initial Setup- Install batteries	09
Initial Setup- Set Date and Time	10
Installation	12
Live View	15
Playback-Photo Visitor Log	16
Low light enhancement	18
Auto-detect switch	18
Micro USB port	19
LED indicator	19
File format - AVI	20
File format - JPEG	22
About overwrite history	24
Go to menu setting screen	26
Menu setting-	27
File Format	27
Band filter	27
Set the Date & Time	28
Reset	28
Limitations of the Ambient light sensor	29
Specification	30

Thank you for purchasing a Brinno product!

The primary entrance point to most homes is the front door. Most homes have a peephole as a means of seeing who is at the door. The peephole hasn't changed much since it was invented in 1932.

Brinno has perfected the Peephole with their latest Motion Activated Digital Peephole Camera/Viewer; the PHVMAC. The PHVMAC will detect when someone approaches your door, turn itself on and display a clean crisp image on the 3 inch TFT LCD inside the door and store a time and date stamped video of the person on a Micro SD Card. The PHVMAC uses the traditional Peephole thus not alerting anyone outside the door they are being photographed. Battery saving technology allows the PHVMAC to last for approximately 9000 peeps, so even if you are away on a two week or two month vacation the PHVMAC will continue to record who was at your door. When returning home you simply push a button to review who was at your door that day. You can easily go back and review any day at the push of a button. All the photos are time and date stamped and stored as a video file, and can be down loaded to a PC any time for long term storage. Want to know if they really tried to deliver your package? Now you will know. Want to catch the kids playing "Knock Knock" ? It's easy. Low light and bright light settings allow you to adjust for the time of day, dusk or high noon. An easy to use menu and simple Icons on the LCD panel allow you set it up the way you want it and review the photos quickly and simply.

Now you really know who was at your front door when you were away.

PHV MAC Features

- 3" LCD panel to display any visitor's image
- Time and date stamped photos, or videos, of everyone who comes to your door
- One button replay on the LCD panel of the day's visitors, any days visitors
- Activated by motion, the Camera records photos or videos of visitors even when no one is home
- The Micro SD Card (if included with purchase), will store the photos of anyone who approaches your door
- 4 AA batteries last for 9,000 triggers
- Low light enhancement
- The Ambient light sensor works through the peephole
- The traditional Peephole is used so as not to alert visitors they are being recorded
- Use the LCD Panel to see whoever is at your front door without them seeing you!

For more info:



Package Contents

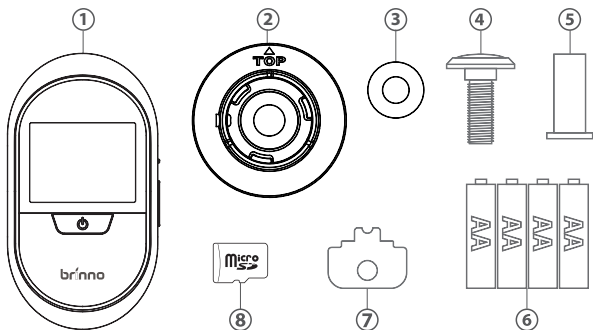

1. Motion Activated PeepHole Camera
2. Base flange
3. Washer(Only for PHV MAC12)
4. PeepHole lens
5. PeepHole barrel
6. 4 AA Batteries
7. Tightening tool
8. Micro SD card(If included with purchase)

▲ For best results please use the peephole included.

Device Parts

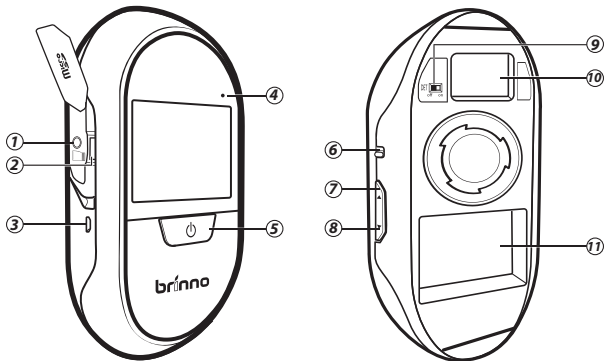

1. Locking screw
2. Micro SD card slot
3. Micro USB port (Page 17)
4. LED indicator (Page 17)
5. Power button
6. Low light enhancement switch (Page 16)
7. Up button
8. Down button
9. Auto- detect switch (Page 16)
10. Extension port
11. Battery sockets

Display Icons

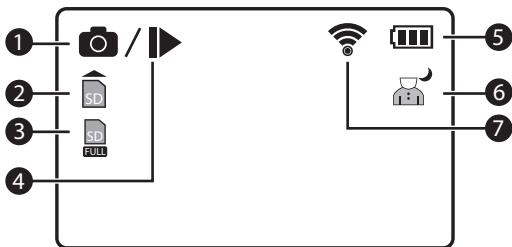

1. Image recording
2. No Micro SD card / Micro SD card error
(Please replace SD card)
3. Micro SD card full
(Please download files to clear SD card space.)
4. Playback
5. Battery status
6. Low light enhancement active
7. Motion activated

Initial Setup- Install batteries

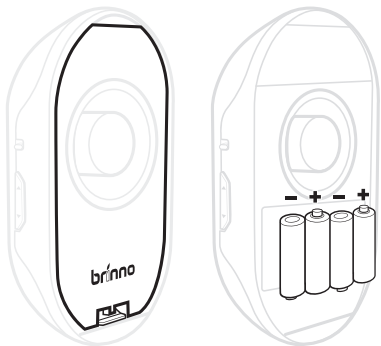

1. Open battery cover
2. Install 4 AA batteries

Initial Setup- Set Date & Time

①



1. Press the **Power button** for 1 second to go to the preview screen.

②



③

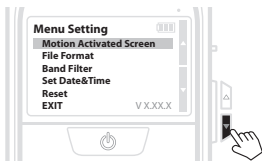

2. At the preview screen, hold the **Up button** for 3 seconds, the menu setting screen will appear.
3. On the Main Menu setting screen, use the **Down button** to go to the Set Date & Time option.

④

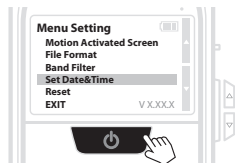

⑤

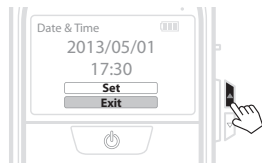

4. Press **Power button** to select the Time & Date menu.
5. Choose the Set option, using the **Up button**.

Initial Setup- Set Date & Time



6. Press **Power button** to select the Set option.

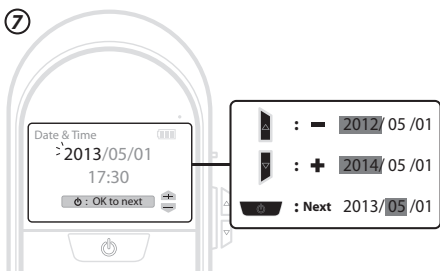

7. Set the date and time

Using the **Up and Down buttons**. As the date flashes, press the **Up button** to get a higher number, and press the **Down button** to get a lower number. Press **Power button** to go to the next field.

When finished, press the **Power button** to exit.

Installation

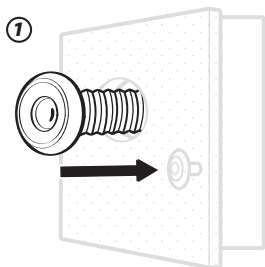

1. Insert Peephole lens in the outside of the door.

② PHV MAC12

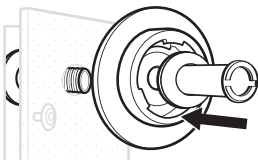

For the 12mm peephole
(North America users most likely.)
Insert the PeepHole barrel through the Washer and Base Flange and insert both into the hole on the inside of the door. Tighten the PeepHole Barrel with your fingers.

PHV MAC14

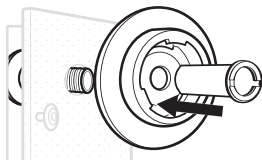

For the 14mm peephole
Insert the peephole barrel through base flange and insert both into the hole on the inside of the door. Tighten the PeepHole Barrel with your fingers.

Installation

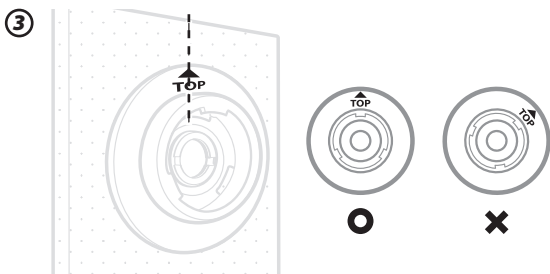

3. When the barrel is snug, rotate the Base Flange until the TOP icon is at 12 o'clock (vertical).



4. Use the Tightening Tool included to tighten the PeepHole barrel.

Installation

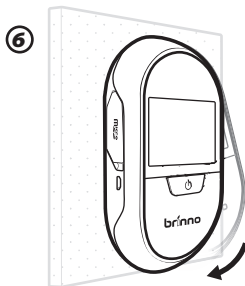
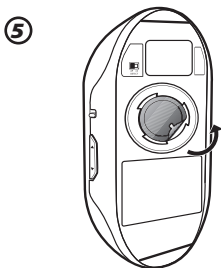

5. Remove PE film over the camera lens on the back.
6. Place the PHV MAC on the flange on a slight counter clock wise angle and rotate the PHV MAC clockwise until horizontal and you feel it lock in place.

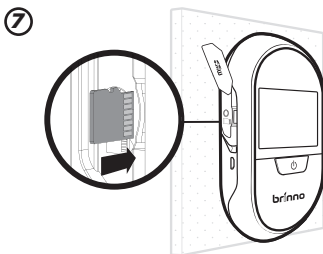

7. Insert the Micro SD Card in the slot as shown. Use the screwdriver to tighten the Locking Screw, if necessary. You are now ready to turn on the Motion Activated PeepHole Camera!

Live View

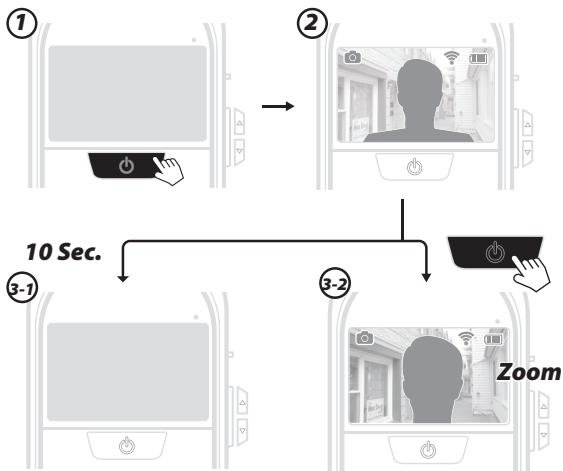

1. Press the **Power button**.
2. The LCD Panel Screen will display who is at the door
- 3-1. After 10 seconds, the screen will shut off to save the power.
- 3-2. To *Zoom* in on the person at the door, press the **Power button** again. You can toggle in and out of *zoom* mode with the **Power button**.

Note

During the Live View, the PHV MAC is still recording.

Playback - Photo Visitor Log

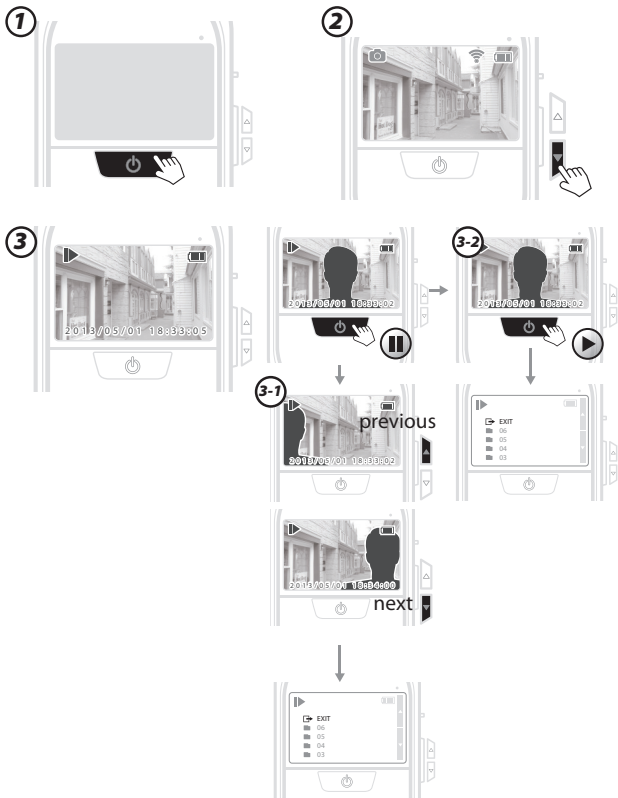

Playback - Photo Visitor Log

1. Press the **Power button**.
2. Enter the "Preview Screen", and just one press the **Down button** to enter auto playback mode.
3. Press the **Power button** to "Pause".

3-1 Single page review

At "Pause" mode, press the **Up button** to see the *previous image*, and press the **Down button** to see the *next image*. When you have seen all your day's images, the screen will go to the daily log folder screen.

3-2 Auto review

You can press **Power button** again to "Play". When you have seen all your day's images, the screen will go to the daily log folder screen.



Note

1. To move to the Daily log folder directly, at pause mode, hold the **Up or Down button**.
2. To leave the auto playback mode, hold the **Power button** for 3 seconds and the preview screen will display.
3. At pause mode, after 10 seconds without any activity, it will go back to preview screen.
4. Playback mode will only play the format to which you are currently set.
5. Playback only support preview function, you can edit or delete your image by computer.

Low light enhancement

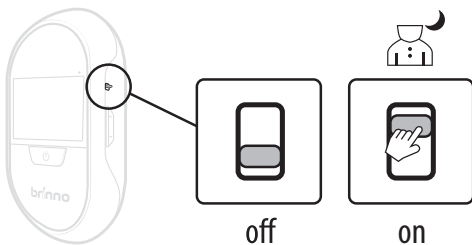

If the lighting conditions outside your door are poor, turning on the Low Light Switch will improve the image.

Auto - detect switch

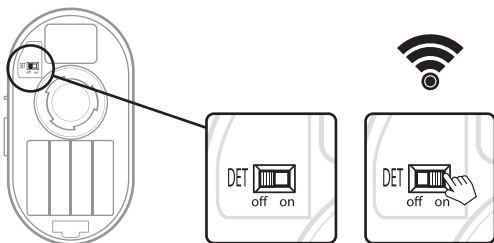

To enable the motion activation feature of the PHV MAC turn the Detect switch to ON. Now anytime someone approaches your door the PHVMAC will wake up and store their photos.
For better battery life you can switch auto detect off when you are home.

Micro USB port

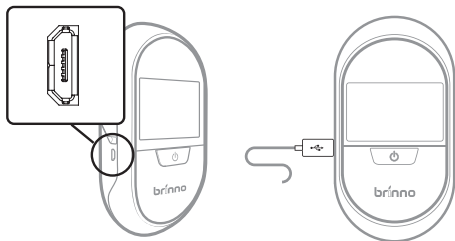

External Power: For long term use, you can attach an external power supply (DC 5V) through the Micro USB connector.

File transfer: You can connect the PHV MAC to your computer to transfer the photos from the Micro SD card to the computer.

OS requirement: Windows XP and above.

LED indicator

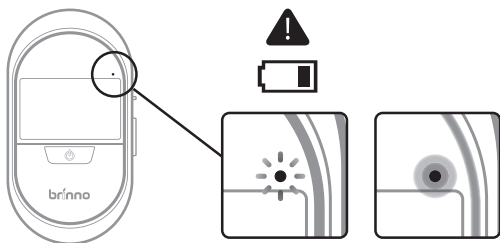

LED flashing: Battery low, please replace the batteries.

LED on : The PHVMAC is **activating** and capturing photos.

⚠ When LED is on, the other buttons will not work.

File format - AVI

Auto Recording



①

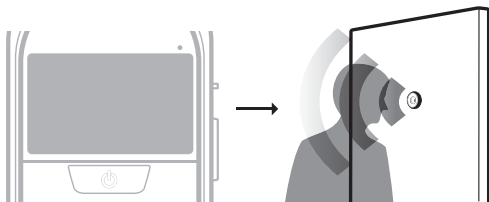

②

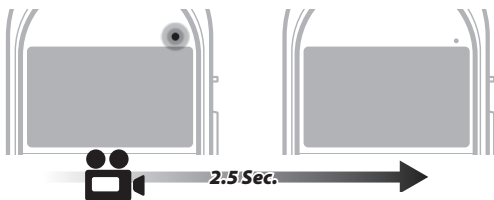

1. The Motion Activated Peephole Camera will detect motion outside the door.
2. The Motion Activated Peephole Camera will wake up and record **2.5-seconds of video**.

⚠ Note

During recording time, the screen will not show any images. Only the red LED will be on, and none of the buttons will work.

File format - AVI

Manually Recording



①

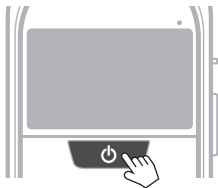

②

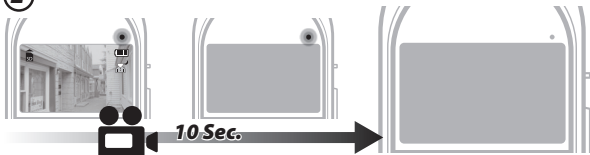

1. Press the **Power button** for 1 second.
2. The Motion Activated Peephole Camera will wake up and record video. Per activation, it will **take 10-seconds of video**.

Note

During recording time, the screen will not show any images. Only the red LED will be on, and none of the buttons will work.

File format - JPEG

Auto Recording DET off on

①

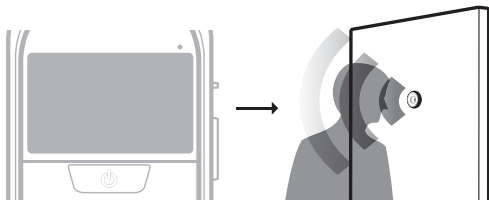

②

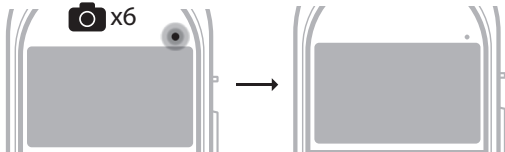

1. The Motion Activated Peephole Camera will detect motion outside the door.
2. The Motion Activated Peephole Camera will wake up and snap photo. Per activation, it will **take 6 photos**.

Note

During recording time, the screen will not show any images. Only the red LED will be on, and none of the buttons will work.

File format - JPEG

Manually Recording



①

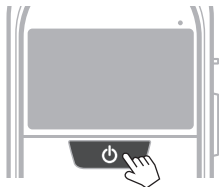

②

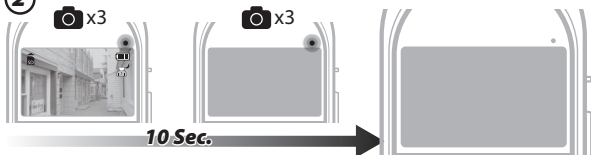

1. Press the **Power button** for 1 second.
2. The Motion Activated Peephole Camera will wake up and snap photo. Per activation, it will **take 6 photos** in 10 seconds. Three are taken immediately, and another three are taken in the last three seconds.

Note

During recording time, the screen will not show any images. Only the red LED will be on, and none of the buttons will work.

About Overwriting History



The Motion Activated PeepHole Camera automatically captures and saves photos when it is motion activated. When the memory is full, the Motion Activated PeepHole Camera will **clean the oldest monthly history, then begin recording new photos**. You may want to regularly download files to a PC to maintain a visual history.

Note

MENU SETTING

Go to Menu Setting screen



Press the **Power button** to go to the preview screen, at the preview screen, hold the **Up button** for 3 seconds, and you will go to the menu setting screen.

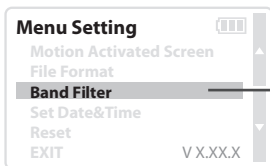

Note
Your selection will be in **orange** to indicate.

MENU SETTING

File Format

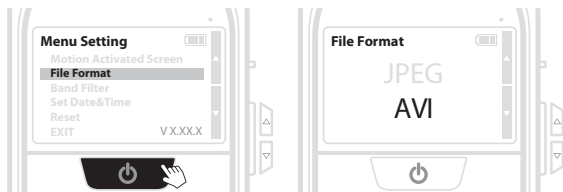

1. Select File format, press the **Power button**.
2. There are AVI and JPEG options.

Band Filter

The band filter setting reduces flicker on the display from interior lighting.

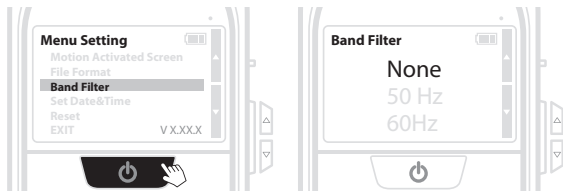

1. Select Band filter, and press the **Power button**.
2. There are three selections:
 - None:** For outdoor environment
 - 50 Hz:** Europe indoors. **60 Hz:** USA indoors.

Note

If the display is flickering, please set the Band filter to the correct setting for your region

MENU SETTING

Set the Date & Time

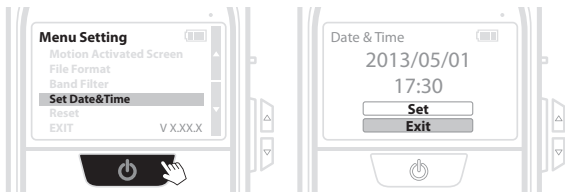

1. Select Set Date & Time, and press the **Power button**.
2. Select Set and press the **Power button** to enter:
At the text flashes, press the **Up button** to increase the number, press the **Down button** to decrease the number, and press **Power button** to go to the next field. When finished, press the **Power button** to exit.

Reset

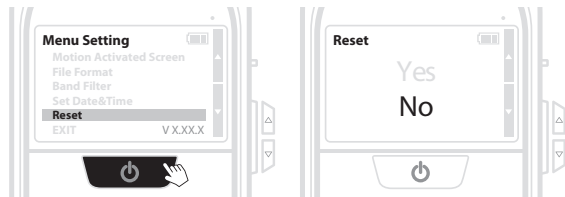

1. Select Reset, press the **Power button**.
2. **Yes**
No

Limitations of the Ambient light sensor

The ambient light sensor is activated by sudden changes in light. Back lit environments are recommended. Front lit environments may impede the sensors ability to trigger.

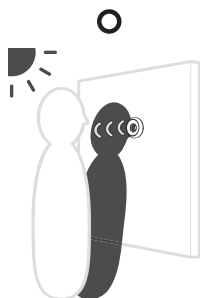

Easy to trigger

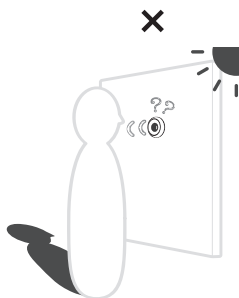

Difficult to trigger

! AVOID

Complicated light environments (e.g. flashing neon lights, flashing head lights, and flashing traffic lights) may confuse the ambient light sensor, and it may be inadvertently activated.



Flashing
Neon



Flashing
Headlights

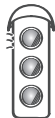

Flashing
Traffic lights

Specification

Model	PHV MAC12
PeepHole Barrel	12 mm
Fits door thick	Fits any door 35~57mm(1.38"~2.24") thick
View angle	Regular mode: 92°, Zoom mode: 40°
Model	PHV MAC14
PeepHole Barrel	14 mm
Fits door thick	Fits any door 40~69mm(1.57"~2.72") thick
View angle	Regular mode: 92°, Zoom mode: 40°
LCD Screen	3.0" TFT
Storage	Micro SD card (Up to 32GB, 8 GB recommend)
File Format	JPEG, AVI
Power Source	4AA batteries (approx. 9,000 triggers)
Contents	PeepHole, Base flange, Tightening tool, 4AA batteries, User manual
Size (WxHxD)	87x158x34 mm (3.39"x6.16"x1.32")
Weight	170g (0.36lb)

www.brinno.com

