



# Pan Lapse

Quick Start Guide

brinno

# Parts of Pan Lapse

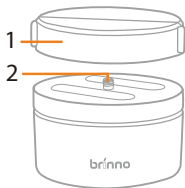

1. Smartphone Clamp
2. Tripod Mount for Camera
3. Tripod Mount

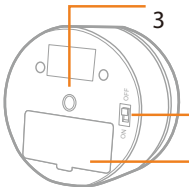

4. Power ON/OFF Switch
5. Battery Cover

## Status LED Indicator

6. Red: Battery Low
7. Green: Power On  
Non-Stop Rotating
- Green Light Blink: Time Lapse working
8. Blue: Bluetooth Connecting

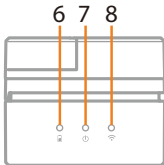

## Power On

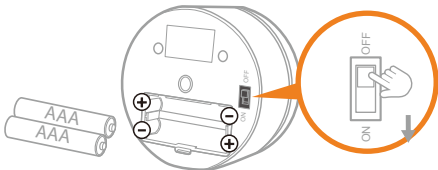

## Smartphone Clamp

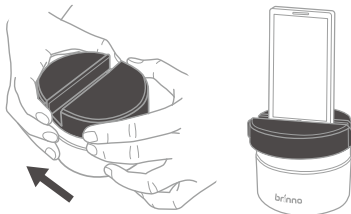

## Camera Tripod Mount

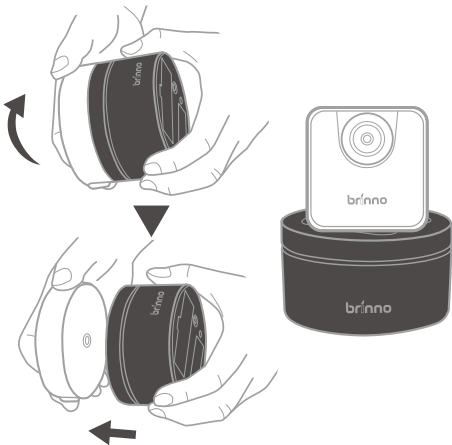

# Caution



# Installing Brinno Pan Lapse APP on your smartphone



For more information please go to:  
[www.brinno.com/art200](http://www.brinno.com/art200)



# Brinno APP

1

Open APP



2

Turn on Bluetooth

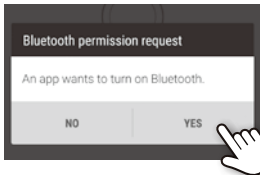

\* Only in the status of your smartphone bluetooth off , the asking screen will pop up when open app.

3

1. Scan Device
2. Select **Brinno\***



\* You may rename your device. ( Six characters limited)



# Setting

1. Set Speed  
1: Slow  
10: Fast  
 $\infty$ : Non Stop(Fastest)
2. Set Time Interval  
(This time interval should match the setting on your time lapse camera.)
3. Set Panning Angle  
(Back-and-forth sweeping)
4. Press "OK"
5. Choose Direction and Start

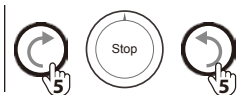
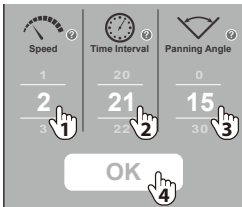

## Tip-1

### Video Recording:

When Speed Setting is " $\infty$ " with time interval " $0$ ",  
Pan Lapse will Non-Stop Rotating.

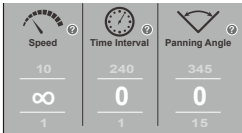

### Time Lapse Recording:

Speed setting should not be " $\infty$ ".  
Time Interval setting should not be " $0$ ".

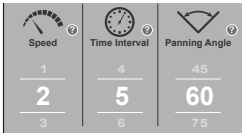

## Tip-2

### How To Set Perfect Panning Angle?

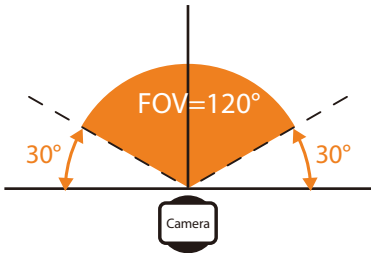

### Ex:

If camera Fov=120°

Plan to shoot a 180° panning time lapse

Panning angle =  $180^{\circ} - 120^{\circ} = 60^{\circ}$

## Tip-3

### What setting should I use?

| Status (Time Lapse) | Speed | Time Interval | Panning Angle |
|---------------------|-------|---------------|---------------|
| Scenery             | 3-5   | 3-5           | On demand     |
| Party               | 7     | 1             | 345°          |

| Status | Speed | Time Interval | Panning Angle |
|--------|-------|---------------|---------------|
| Video  | ∞     | 0             | On demand     |

### Note

FCC

FEDERAL COMMUNICATIONS COMMISSION INTERFERENCE STATEMENT

This equipment has been tested and found to comply with the limits for a Class B digital device, pursuant to Part 15 of the FCC Rules. These limits are designed to provide reasonable protection against harmful interference in a residential installation. This equipment generates, uses and can radiate radio frequency energy and, if not installed and used in accordance with the instructions, may cause harmful interference to radio communications. However, there is no guarantee that interference will not occur in a particular installation. If this equipment does cause harmful interference to radio or

television reception, which can be determined by turning the equipment off and on, the user is encouraged to try to correct the interference by one or more of the following measures:

- Reorient or relocate the receiving antenna.
- Increase the separation between the equipment and receiver.
- Connect the equipment into an outlet on a circuit different from that to which the receiver is connected.
- Consult the dealer or an experienced radio/TV technician for help.

**CAUTION:**

Any changes or modifications not expressly approved by the party responsible for compliance could void the user's authority to operate the equipment.

This device complies with part 15 of the FCC Rules. Operation is subject to the following two conditions:

- (1) This device may not cause harmful interference, and
- (2) this device must accept any interference received, including interference that may cause undesired operation.

**FCC RF Radiation Exposure Statement:**

1. This Transmitter must not be co-located or operating in conjunction with any other antenna or transmitter.
2. This equipment complies with FCC RF radiation exposure limits set forth for an uncontrolled environment.

This equipment should be installed and operated with a minimum distance of 20 centimeters between the radiator and your body.

Brinno Makes Time Lapse Easy



301-0084-10 EN A2